



**MESKER®**  
SINCE 1879

**Your Trusted Source  
for Hollow Metal**

Since 1879, Mesker has been the trusted hollow metal source for commercial construction projects. Mesker offers the pinnacle of innovation, craftsmanship, and quality for hollow metal doors and frames today. With a wide portfolio of quality products, Mesker offers the best-in-class service and has become one of the most recognizable steel door companies in the world.

## TABLE OF CONTENTS

<b>PAGE 02</b>	LOCATIONS STOCK & INVENTORY
<b>PAGE 03</b>	LEAD TIME & PROJECT SERVICES
<b>PAGE 04</b>	CERTIFICATIONS & AFFILIATIONS
<b>PAGE 05</b>	COMMERCIAL DOORS N-SERIES DOORS NVS SEAMLESS DOORS EMBOSSSED & WOODGRAIN DOORS ST-SERIES STEEL-STIFFENED DOORS NF-SERIES TEMPERATURE RISE DOORS ADDITIONAL DOOR OPTIONS
<b>PAGE 13</b>	COMMERCIAL FRAMES F-SERIES FRAMES - SINGLE RETURN DW-SERIES FRAMES - DOUBLE RETURN RF-SERIES REMODELING FRAMES ADJ-SERIES ADJUSTABLE FRAMES FF-SERIES FLUSH FACE FRAMES WELDED FRAMES & ELEVATIONS ADDITIONAL FRAME OPTIONS
<b>PAGE 21</b>	CERTIFIED DOOR/FRAME ASSEMBLIES SOUND TRANSMISSION CLASS (STC) SEVERE WEATHER - RESIDENTIAL SHELTER TORNADO SEVERE WEATHER - COMMUNITY SHELTER TORNADO SEVERE WEATHER - HURRICANE BR-SERIES BULLET RESISTANT

## LOCATIONS



PROUDLY ENGINEERED AND  
MANUFACTURED IN THE UNITED  
STATES OF AMERICA

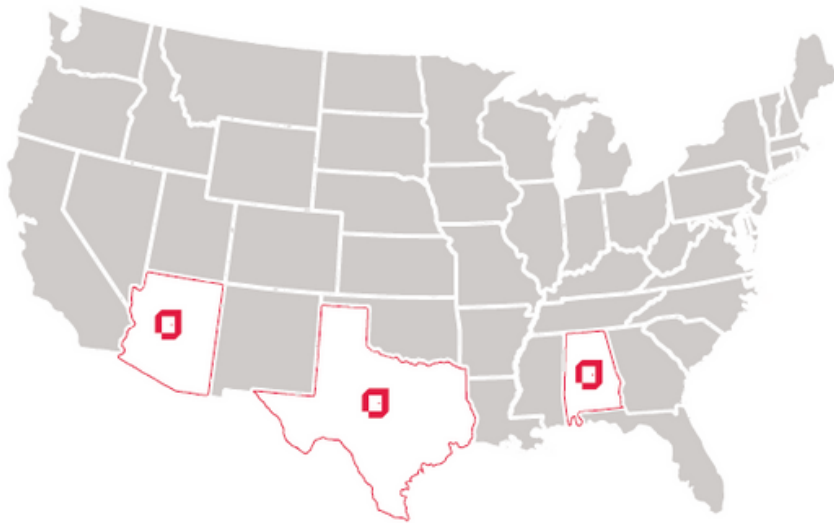

**MESKER DOOR**  
HUNTSVILLE, AL

**MESKER SERVICE CENTER**  
DALLAS, TX

**HOLLOW METAL XPRESS**  
PHOENIX, AZ



## STOCK & INVENTORY

Each Mesker MBM location holds stock inventory that is readily available! Reach out to your local sales representative for a list of stock items.



# LEAD TIME & PROJECT SERVICES

## SUPPORTING ANY PROJECT REQUIREMENT

Built on the mentality of delivering quality products quickly, Mesker offers a wide range of lead time service options to support any project requirement.

- Wide range of Xpress lead time services
- Quoting and order processing through our knowledgeable sales and customer service staff
- Professional packaging to ensure your hollow metal doors and frames arrive in excellent condition
- Multiple freight and delivery options available

### MESKER QUICK SHIP SERVICES\*

Turbo (same day)	□
1-Day	■
3-Day	■ ■ ■
5-Day	■ ■ ■ ■ ■
7-Day	■ ■ ■ ■ ■ ■ ■
10-Day	■ ■ ■ ■ ■ ■ ■ ■ ■ ■

Contact your Territory Manager or local representative for other flexible options to align with project requirements.

\* Orders may be subject to capacity and other restrictions.

## CONTACT US

PHONE: 256.851.6670



ESTIMATES  
[quotes@mesker.us](mailto:quotes@mesker.us)



ORDERS  
[mesker.orders@mesker.us](mailto:mesker.orders@mesker.us)



CUSTOMER SERVICE  
[customer.service@mesker.us](mailto:customer.service@mesker.us)

# CERTIFICATIONS & AFFILIATIONS

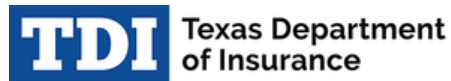

# COMMERCIAL DOORS

Mesker boasts one of the largest portfolios of commercial door products from a single hollow metal manufacturer. We offer an array of door styles to compliment the most challenging and aesthetically pleasing architectural specifications. Mesker has many critical-to-quality features that have established our products as the quality leader in the commercial construction industry.

## SUPERIOR CONSTRUCTION

- Tab-and-Slot construction mechanically locks the pan and lid together
- Projection welds on all corners
- Adaptable non-handed design standard; beveled edges optional
- Premium high-frequency top hinge reinforcement adds strength and durability where other doors fail most often
- 14 ga. closer reinforcements included
- Versatile top/bottom channels with optional embossed flush bolt guides
- NVS heavy-duty fully welded edge door option = strength of steel stiffened door without the additional weight burden
- Variety of vision lite kit, louver, and panel design options available

Superior Tab-and-Slot Construction

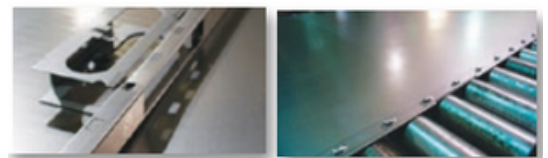

Premium High-Frequency  
Top Hinge Reinforcement

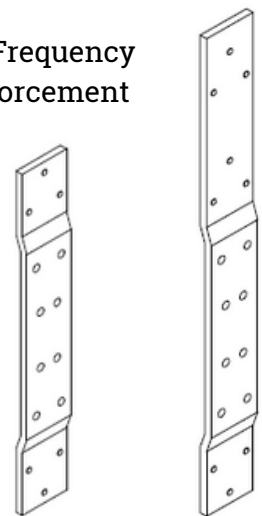

Standard

High-Frequency

# COMMERCIAL DOORS

## STRONGEST MATERIALS

- Door Skins: 18 ga. standard; 16 ga. and 14 ga. optional
- Steel Type: A40 galvanized steel standard; A60 galvanized and G90 galvanized optional
- Extra heavy-duty 7 ga. hinge reinforcements

## INNOVATIVE CORE SOLUTIONS

- 1LB polystyrene standard
- PUR glue system securely bonds core and skins for long-term durability
- Steel stiffeners available
- Additional options: honeycomb, polyurethane, fiberboard, and high-density polystyrene

## DURABLE FINISH

- Mesker anti-corrosion primer standard
- G90 galvanized products are unprimed

## CERTIFICATIONS

- Up to 3-hr fire rating - FM, UL, Intertek
- Temperature rise
- Windstorm: FEMA, Florida Building Code (FBC), Miami-Dade NOA, Texas Department of Insurance (TDI)
- Other certifications/ratings: UL752 Bullet Resistance and Sound Transmission Class (STC)

## THERMAL RATINGS

- Polystyrene: U factor .41; R value of 2.33
- Polyurethane: U factor .39; R value of 2.48

# N-SERIES DOORS

## LEGENDARY DESIGN AND DURABILITY

Mesker's square edge, non-handed N-Series door meets the requirements of virtually any opening - from sound deadening and energy cost reduction to various levels of fire ratings. They come in a range of gauges, sizes, and styles and can be custom manufactured to meet unique design requirements.

## CONSTRUCTION

- Tab-and-Slot construction mechanically locks the pan and lid together
- Projection welds on all corners
- Adaptable non-handed design standard; beveled edges optional
- Premium high-frequency top hinge reinforcement adds strength and durability where other doors fail most often
- 14 ga. closer reinforcements included
- Versatile top/bottom channels with optional embossed flush bolt guides
- Door Skins: 18 ga. standard; 16 ga. and 14 ga. optional
- Steel Type: A40 galvanized steel standard; A60 galvanized and G90 galvanized optional
- Extra heavy-duty 7 ga. hinge reinforcements

## DURABLE FINISH

- Mesker anti-corrosion primer standard
- G90 galvanized products are unprimed



## CERTIFICATIONS

- Up to 3-hr fire rating - FM, UL, Intertek
- Windstorm: Florida Building Code (FBC), Miami-Dade NOA, Texas Department of Insurance (TDI)

## INNOVATIVE CORE SOLUTIONS

- 1LB polystyrene standard
- PUR glue system securely bonds core and skins for long-term durability
- Steel stiffeners available (ST Series)
- Additional options: honeycomb, polyurethane, fiberboard, and high-density polystyrene



# NVS DOORS

## UNCOMPROMISING STRENGTH WITHOUT THE WEIGHT

Mesker's NVS seamless edge doors have revolutionized the industry with a unique combination of strength, durability, and aesthetics - at the weight of a standard door. The NVS door outperformed traditional steel-stiffened doors in the Steel Door Institute (SDI) twist test, the industry measure of door strength and performance.

### CONSTRUCTION

- Tab-and-Slot construction mechanically locks the pan and lid together
- Continuously welded, seamless door edges
- Projection welds on all corners
- Adaptable non-handed design standard; beveled edges optional
- Premium high-frequency top hinge reinforcement adds strength and durability where other doors fail most often
- 14 ga. closer reinforcements included
- Door Skins: 16 ga. standard; 18ga. and 14 ga. optional
- Steel Type: A40 galvanized steel standard; A60 galvanized and G90 galvanized optional
- High-density polystyrene core standard
- Extra heavy-duty 7 ga. hinge reinforcements
- NVS standard on FEMA rated openings

### DURABLE FINISH

- Mesker anti-corrosion primer standard
- G90 galvanized products are unprimed

### CERTIFICATIONS

- Up to 3-hr fire rating - FM, UL, Intertek
- Windstorm: FEMA, Florida Building Code (FBC), Miami-Dade NOA, Texas Department of Insurance (TDI)

Construction	Traditional Steel-Stiffened	Mesker NVS Door
Aesthetics	Blemishes and burn marks from welding stiffeners to skins can often show through the finish paint	<b>No welding to faces = smooth faces and no blemishes showing through finish paint</b>
Weight	Can add 80-90 lbs. of weight to the door	<b>Standard weight of a comparable gauge door</b>
Cost	Adds significant cost to door as well as potentially required heavy-weight hardware to adequately handle additional weight	<b>No additional cost required for steel-stiffeners or heavy-duty hardware</b>

# EMBOSSED & WOODGRAIN DOORS

## CLASSIC DESIGN WITH THE STRENGTH OF STEEL

Call on Mesker's Embossed and Woodgrain Doors when design and style are desired, but strength and durability are paramount. This series offers a wide range of panel options including 1-panel, 2-panel square and arch top, 4-panel, 6-panel plus woodgrain embossed flush and 6-panel doors.

## CONSTRUCTION

- Tab-and-Slot construction mechanically locks the pan and lid together
- Projection welds on all corners
- Adaptable non-handed design standard; beveled edges optional
- Premium high-frequency top hinge reinforcement adds strength and durability where other doors fail most often
- 14 ga. closer reinforcements included
- Versatile top/bottom channels with optional embossed flush bolt guides
- Door Skins: 18 ga. standard, 16 ga. available by special order (quantity minimums may apply)
- Steel Type: A40 galvanized steel standard
- Extra heavy-duty 7 ga. hinge reinforcements
- 1LB polystyrene core standard
- Most designs require 2'8" minimum door width to accommodate lock preps



## CERTIFICATIONS

- Up to 3-hr fire rating - FM, UL, Intertek
- Windstorm: Florida Building Code (FBC), Miami-Dade NOA, Texas Department of Insurance (TDI)
- ADA bottom rail available

## DURABLE FINISH

- Mesker anti-corrosion primer standard
- Optional as unprimed for staining/painting by others

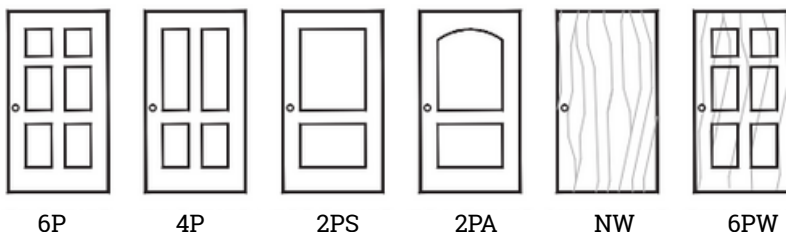

Consult the Mesker  
Price List for  
Current Offering

# ST-SERIES STEEL-STIFFENED DOORS

## TRADITIONAL STRENGTH AND DURABILITY

Mesker's ST-Series doors are traditionally designed for strength and durability by integrating the features and benefits of the N-Series with full-length steel stiffeners.

## CONSTRUCTION

- Tab-and-Slot construction mechanically locks the pan and lid together
- 18 ga. steel-stiffeners run the full length of the door, approximately 6" on center
- Projection welds on all corners
- Adaptable non-handed design standard; beveled edges optional
- Premium high-frequency top hinge reinforcement adds strength and durability where other doors fail most often
- 14 ga. closer reinforcements included
- Versatile top/bottom channels with optional embossed flush bolt guides
- Door Skins: 16 ga. standard; 14 ga. optional
- Steel Type: A40 galvanized steel standard; A60 galvanized and G90 galvanized optional
- Extra heavy-duty 7 ga. hinge reinforcements
- Segmented polystyrene core standard; mineral wool or polyurethane core optional



## CERTIFICATIONS

- Up to 3-hr fire rating - FM, UL, Intertek
- Windstorm: Florida Building Code (FBC), Miami-Dade NOA, Texas Department of Insurance (TDI)

## DURABLE FINISH

- Mesker anti-corrosion primer standard
- G90 galvanized products are unprimed

# TR-SERIES TEMPERATURE RISE DOORS

## BEST-IN-CLASS HEAT TRANSMISSION

The Mesker temperature rise door has a best-in-class rating for heat transmission, as tested by Underwriters Laboratory in accordance with ASTM E152. Our unique design, in conjunction with a premium fiberboard core, will keep the side of the door not exposed to fire below 250°F for 30 minutes. This is superior to other manufacturers 400°F units which can remove human skin if touched.

## CONSTRUCTION

- Premium fiberboard core - keeps the non-exposed side of the door below 250 degrees for 30-minutes
- Tab-and-Slot construction mechanically locks the pan and lid together
- Projection welds on all corners
- Adaptable non-handed design standard; beveled edges optional
- Premium high-frequency top hinge reinforcement adds strength and durability where other doors fail most often
- 14 ga. closer reinforcements included
- Versatile top/bottom channels with optional embossed flush bolt guides
- Door Skins: 18 ga. standard; 16 ga. and 14 ga. optional
- Steel Type: A40 galvanized steel standard; A60 galvanized and G90 galvanized optional
- Extra heavy-duty 7 ga. hinge reinforcements
- Vision lite kits up to 100 sq. in.



## CERTIFICATIONS

- Up to 3-hr fire rating

## DURABLE FINISH

- Mesker anti-corrosion primer standard
- G90 galvanized products are unprimed

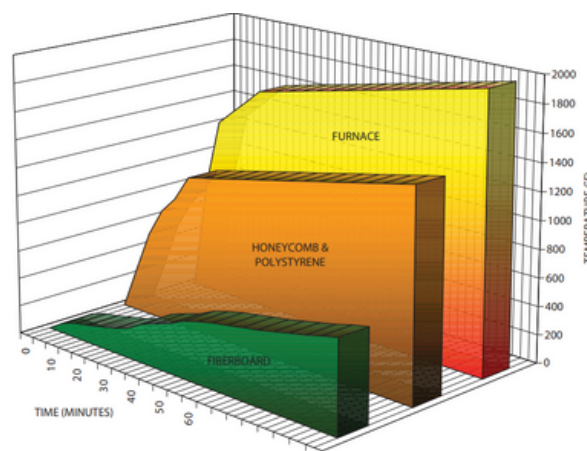

# ADDITIONAL DOOR OPTIONS

## CORE OPTIONS



POLYSTYRENE

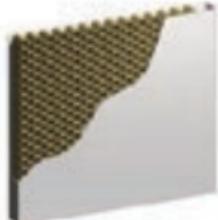

HONEYCOMB



STEEL STIFFENED



POLYURETHANE



FIBERBOARD

- Honeycomb: made from cardboard shaped into a honeycomb. Can be fire rated up to 3-hours and due to the lower insulation values are generally used for interior applications and can be used for sound performance.
- Polyurethane: Add extra insulating value to Mesker doors, ensuring improved energy efficiency. Combined with a thermal break frame and appropriate weatherstripping to create a thermal opening ready to resist the elements.
- Polystyrene: U factor .41; R value 2.33; Polyurethane: U factor .39; R value 2.48

## LEAD LINED DOORS & FRAMES

- Available from Mesker's Dallas Service Center and Hollow Metal Xpress (HMX)
- Lead lined offering includes factory installed lead, lead line clips only for frames (lead by others), as well as 2LB (1/32" thick) and 4LB (1/16" thick) lead lining in both doors and frames
- Thicker lead lining options may be available - contact your local sales representative
- Frame fire ratings are available through UL, Intertek, and Guardian
- Door fire ratings are available through Guardian
- Lead lining typically used in areas such as medical offices and hospitals where radiation shielding is required

## DUTCH DOOR AND DUTCH DOOR SHELVES

- Dutch door units provide the necessary room-to-room safety and security without sacrificing visibility and communication. These doors are ideally suited for child care facilities, front offices, churches, hospitals, and other applications where frequent transactions occur
- Separate top and bottom door leafs
- Door leafs can be prepped for cylindrical or mortise locks
- Door can be prepped for vision lite kit or louver
- Optional dutch door shelves available (non-fire rated openings only)
- Fire rated dutch doors are available



# COMMERCIAL FRAMES

Similar to the door portfolio, Mesker offers a complete line of hollow metal frames which boast the ingenuity and ruggedness you expect. Our frames are quality engineered, resulting in long frame life with best-in-class fit and finish. Mesker's strength not only comes from a storied history of innovative engineering and design, but also premium components and incredible value for our partners.

## SUPERIOR CONSTRUCTION

- Brake Press Forming - tight, crisp bends and corners are not only aesthetically pleasing but also create a great fit-up for smooth welding transitions
- 16 ga. standard; 14 ga. and 12 ga. available
- Steel Type: A40 galvanized standard; A60 galvanized and G90 galvanized optional
- Extra heavy-duty 7 ga. hinge reinforcements for maximum load strength and resistance to door sag
- 14 ga., projection welded, one-piece strike reinforcements ensures optimal safety and security
- Factory installed plaster guards standard on all F-Series strike and hinge jambs
- 16 ga. floor anchors standard
- Optional 14 ga. closer reinforcements
- Wide selection of anchors available for a variety of wall and floor applications

## FRAME PROFILES & TYPES

- Double return (drywall)
- Single return (masonry)
- Double egress, kerf, and thermal break
- Flush face, cased open, hospital stops
- Adjustable and remodel frames

## FRAME RABBET

- Unequal rabbet (standard)
- Equal rabbet
- Single rabbet

## WELDED FRAMES, STICK, ELEVATIONS

- 3-sided welded frames (face & continuous)
- Transom and side lites
- Custom elevations
- Curved and arch top frames (HMX)
- Mullion and stick
- Cut and notch program

# F-SERIES FRAMES

## SINGLE RETURN - MASONRY

Mesker's F-Series frames are the best stock hollow metal assemblies in the industry. Quality raw material options include 16 ga. standard (14 ga. and 12 ga. optional) and A40 galvanized coating standard (A60 galvanized and G90 galvanized optional).

## CONSTRUCTION

- Brake Press Forming - tight, crisp bends and corners are not only aesthetically pleasing but also create a great fit-up for smooth welding transitions
- Mitered corners with strong 4-tab interlocking system
- Gauge: 16 ga. standard; 14 ga. and 12 ga. optional
- Steel Type: A40 galvanized standard; A60 galvanized and G90 galvanized optional
- Hinge Reinforcements: extra heavy-duty 7 ga. for maximum load strength and resistance to door sag
- Strike Reinforcements: 14 ga., projection welded, one-piece reinforcements ensures optimal safety and security
- Rabbet: Unequal rabbet standard; equal rabbet, single rabbet, cased open, communicating, double egress by specification
- Available closer reinforcements in 14 ga.
- Factory installed plaster guards standard on all F-Series strike and hinge jambs
- 16 ga. floor anchors standard
- Wide selection of anchors available for a variety of wall and floor applications
- Knock down standard, available face weld or continuous weld



## CERTIFICATIONS

- Embossed UL on hinge jamb for up to 3-hr fire rating
- Also available with UL or Intertek metal labels, or mylar labels from UL, Intertek or FM

## DURABLE FINISH

- Mesker anti-corrosion primer standard
- G90 galvanized products are unprimed

# DW-SERIES FRAMES

## DOUBLE RETURN - DRYWALL

Mesker's DW-Series frames could very well be the quickest and easiest door frame to install. A new innovative corner locking system promotes a quick and simple install - with fewer components to assemble than other frame products.

## CONSTRUCTION

- Brake Press Forming - tight, crisp bends and corners are not only aesthetically pleasing but also create a great fit-up for smooth transitions
- 3-piece knock down frame
- Mitered with easy-install corner locking design
- Gauge: 16 ga. standard; 14 ga. optional
- Steel Type: A40 galvanized standard; A60 galvanized and G90 galvanized optional
- Hinge Reinforcements: extra heavy-duty 7 ga. for maximum load strength and resistance to door sag
- Strike Reinforcements: 14 ga., projection welded, one-piece reinforcements ensures optimal safety and security
- Rabbet: Unequal rabbet standard; equal rabbet, single rabbet, cased open, communicating, double egress by specification
- Available closer reinforcements in 14 ga.
- Compression anchor with base sill holes standard; optional strap anchors available



## CERTIFICATIONS

- Embossed UL on hinge jamb for up to 90-min fire rating standard
- Also available with UL or Intertek metal labels, or mylar labels from UL, Intertek or FM

## DURABLE FINISH

- Mesker anti-corrosion primer standard
- G90 galvanized products are unprimed

# RF-SERIES REMODELING FRAMES

## SPLIT JAMB FRAMES IDEAL FOR REMODELING

Mesker's RF-Series frames are engineered for both durability and flexibility. With 5 standard sizes ranging from 3-1/4" to 9-1/8" wall thicknesses, the RF-Series frames are ideal for remodeling projects.

## CONSTRUCTION

- Split frame design includes 6-piece component layout with overlapping hardware and trim sections
- Knock down standard, face weld available
- Countersunk holes in hardware and trim sections for easy anchoring
- Brake Press Forming - tight, crisp bends and corners are not only aesthetically pleasing but also create a great fit-up for smooth transitions
- Mitered corners with strong 4-tab interlocking system
- Furnished with rubber mutes - 3 per strike jamb
- Gauge: 16 ga. standard; 14 ga. optional
- Steel Type: A40 galvanized standard; A60 galvanized and G90 galvanized optional
- Hinge Reinforcements: extra heavy-duty 7 ga. for maximum load strength and resistance to door sag
- Strike Reinforcements: 14 ga., projection welded, one-piece reinforcements ensures optimal safety and security
- Rabbet: Unequal rabbet only
- Available closer reinforcements in 14 ga.
- Wide selection of anchors available for a variety of wall and floor applications
- 5 standard options to cover wall thicknesses from 3-1/4" to 9-1/8", with larger jamb depths available

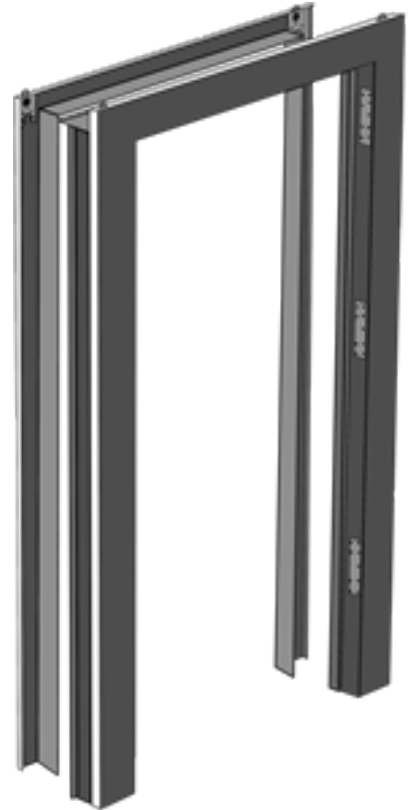

## CERTIFICATIONS

- Embossed UL on hinge jamb for up to 90-min fire rating standard
- Also available with UL metal or mylar labels

## DURABLE FINISH

- Mesker anti-corrosion primer standard
- G90 galvanized products are unprimed

# ADJ-SERIES ADJUSTABLE FRAMES

## ADJUSTABLE FRAMES FOR THE MOST FLEXIBLE INSTALLATION

Mesker's ADJ adjustable frames bring flexibility to installation time. Two standard sizes of frames adjust for ease of installation.

## CONSTRUCTION

- Brake Press Forming - tight, crisp bends and corners are not only aesthetically pleasing but also create a great fit-up for smooth transitions
- Two sizes adjust to a range of wall thicknesses
  - Size 8-3/4 - adjusts for wall thicknesses of 4-5/8" to 7-3/4"
  - Size 12-1/4 - adjusts for wall thicknesses of 7-1/2" to 11-1/4"
- Mitered corners with strong 4-tab interlocking system
- Furnished with rubber mutes - 3 per strike jamb
- Gauge: 16 ga. standard; 14 ga. optional
- Steel Type: A40 galvanized standard; A60 galvanized and G90 galvanized optional
- Hinge Reinforcements: extra heavy-duty 7 ga. for maximum load strength and resistance to door sag
- Strike Reinforcements: 14 ga., projection welded, one-piece reinforcements ensures optimal safety and security
- Rabbet: Double rabbet only
- Available closer reinforcements in 14 ga.

## CERTIFICATIONS

- Embossed UL on hinge jamb for up to 90-min fire rating standard
- Also available with UL metal or mylar labels

## DURABLE FINISH

- Unprimed standard



# FF-SERIES FLUSH FACE FRAMES

## FLUSH FACE FRAMES WITH NO RETURNS

Mesker's FF-Series Flush Face Frames are designed to be installed after the walls are finished. Preset holes allow casing or finish trim to be installed over the flush face of the frame.

## CONSTRUCTION

- Flush face design to "sleeve" the wall and be installed after walls are finished
- Casing/trim to be self-applied (by others)
- Brake Press Forming - tight, crisp bends and corners are not only aesthetically pleasing but also create a great fit-up for smooth transitions
- 3/16" nail/screw holes on face of frame
- No anchors needed - screw applied for easy installation on existing walls/openings
- Mitered corners with strong 4-tab interlocking system
- Furnished with rubber mutes - 3 per strike jamb
- Gauge: 16 ga. standard; 14 ga. optional
- Steel Type: A40 galvanized standard; A60 galvanized and G90 galvanized optional
- Hinge Reinforcements: extra heavy-duty 7 ga. for maximum load strength and resistance to door sag
- Strike Reinforcements: 14 ga., projection welded, one-piece reinforcements ensures optimal safety and security
- Rabbet: Unequal rabbet standard; equal rabbet, single rabbet, cased open, communicating, double egress by specification
- Available closer reinforcements in 14 ga.



## CERTIFICATIONS

- Embossed UL on hinge jamb for up to 90-min fire rating standard
- Also available with UL or Intertek metal labels, or mylar labels from UL, Intertek or FM

## DURABLE FINISH

- Mesker anti-corrosion primer standard
- G90 galvanized products are unprimed

# WELDED FRAMES & ELEVATIONS

## CUSTOM DESIGN AND ENGINEERED ELEVATIONS

Let Mesker's team help design and engineer your custom elevation requirements.



SIDE LITE

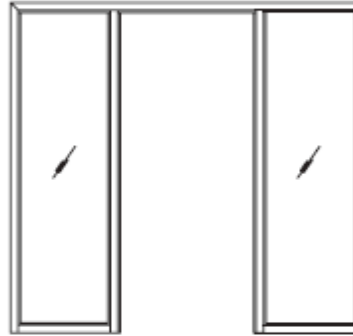

DOUBLE  
SIDE LITE



TRANSOM

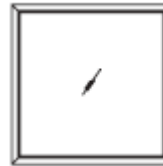

BORROWED LITE  
SINGLE / DOUBLE



## CUSTOM ELEVATIONS

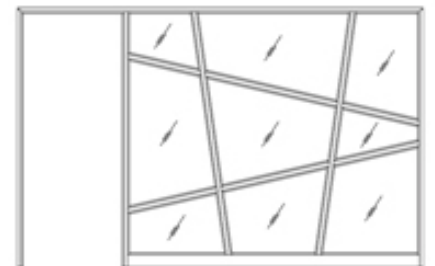
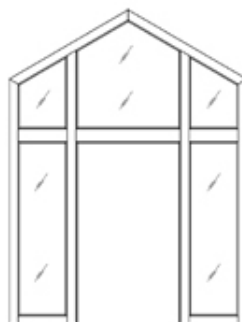

# ADDITIONAL FRAME OPTIONS

## DOUBLE EGRESS FRAMES

- Profile and assembly to permit a means of egress in opposite directions through the same opening
- Single return or double return
- Knock down standard, face weld and continuous weld available



## CASED OPEN FRAMES

- No stop - used in applications with no door, in a walk-through opening
- Available reinforced for applications using double-acting doors
- Single return or double return
- Knock down standard, face weld and continuous weld available



## HOSPITAL STOP FRAMES

- Stops terminate in one of three optional heights: 4", 6", or 8" from the bottom of the frame (6" standard)
- Allows for space to clean areas around the base of the frame
- Enables easier access of hospital bed wheels and wheel chairs



## LEAD LINED DOORS & FRAMES

- Available from Mesker's Dallas Service Center (frames only) and Hollow Metal Xpress (doors and frames)
- Lead lined offering includes factory installed lead, lead line clips only for frames (lead by others), as well as 2LB (1/32" thick) and 4LB (1/16" thick) lead lining in both doors and frames
- Thicker lead lining options may be available - contact your local sales representative
- Frame fire ratings are available through UL, Intertek, and Guardian
- Door fire ratings are available through Guardian
- Lead lining typically used in areas such as medical offices and hospitals where radiation shielding is required

# CERTIFIED DOOR/FRAME ASSEMBLIES

SOUND TRANSMISSION CLASS (STC)  
SEVERE WEATHER ASSEMBLIES  
BULLET-RESISTANT OPENINGS

# SOUND TRANSMISSION CLASS (STC)

## CERTIFIED ACCOUSTICAL SOUND CONTROL OPENINGS

Sound Transmission Class (STC) openings are engineered to preserve an assemblies required sound insulation rating. These openings reduce the amount of sound that is audible on the opposite side of the door. Specified in many medical and counseling offices, offices and conference rooms, multi-family and hotel rooms, industrial sites, and other installations where separation of airborne sound between adjacent spaces is needed.

### CONSTRUCTION

- Uniquely engineered and manufactured to reduce sound transmission from space-to-space
- Assemblies include door(s), frame, and sound seals
- Frames, door skins, and cores dependent on STC rating
- Steel Type: A40 galvanized steel standard; other steel types may be available

### CERTIFICATIONS

- Up to 3-hr fire rating - FM, UL, Intertek

### DURABLE FINISH

- Mesker anti-corrosion primer standard

STC RATING / MODEL #:	
SINGLE DOOR OPENING	PAIRED DOOR OPENING
STC35	
STC43	
STC45	STC45PR
STC46	
	STC47PR
STC48	
STC49	
STC50	STC50PR
STC52	
STC53	

STC RATINGS CHART		
STC	PERFORMANCE	DESCRIPTION
20-25	VERY POOR	LOW SPEECH AUDIBLE
25-30	POOR	NORMAL SPEECH UNDERSTOOD EASILY
30-35	FAIR	LOUD SPEECH UNDERSTOOD FAIRLY WELL
35-40	GOOD	LOUD SPEECH HEARD BUT HARDLY INTELLIGIBLE
45-50	VERY GOOD	LOUD SPEECH HEARD FAINTLY
50-60	EXCELLENT	LOUD SOUNDS HEARD FAINTLY OR NOT AT ALL

- The STC rating is calculated in accordance with ASTM E413
- It's a single number rating for interior building partitions that are subjected to mid to high frequency noises
- The higher the number, the better the noise isolation
- Standard steel doors often have an STC rating in the 25-35 range
- Specifying a door with an STC rating in the 40s is adequate in most situations, but in settings where sound control is critical, such as an office where confidential meetings are held, doors above STC 45 may be needed



# SEVERE WEATHER - TORNADO FEMA ICC-500 RESIDENTIAL (320)

## TORNADO RATED ASSMBLIES FOR RESIDENTIAL STORM SHELTER APPLICATIONS

Mesker's tornado rated assemblies are engineered to withstand requirements in the ICC-500 Standard for the Design and Construction of Residential Storm Shelters. These assemblies include a 14 ga. door with a 14 ga. frame combined with 3 Grade 1 deadbolts and a Grade 1 lockset to create an opening solution that is ideal for storm shelters and high-security safe rooms.

### CONSTRUCTION

- 14 ga. NVS or steel stiffened door
- Tab-and-Slot construction mechanically locks the pan and lid together
- Projection welds on all corners
- Adaptable non-handed design standard; beveled edges optional
- Premium high-frequency top hinge reinforcement adds strength and durability where other doors fail most often
- 14 ga. closer reinforcements included
- Versatile top/bottom channels with optional embossed flush bolt guides
- Door Skins: 14 ga.
- Frame: 14 ga.
- Hardware: (3) Grade 1 deadbolts with (1) Grade 1 lockset
- Steel Type: A40 galvanized steel standard; A60 galvanized and G90 galvanized optional
- Extra heavy-duty 7 ga. hinge reinforcements

### CERTIFICATIONS

- Up to 3-hr fire rating - FM, UL, Intertek
- FEMA ICC-500 Residential

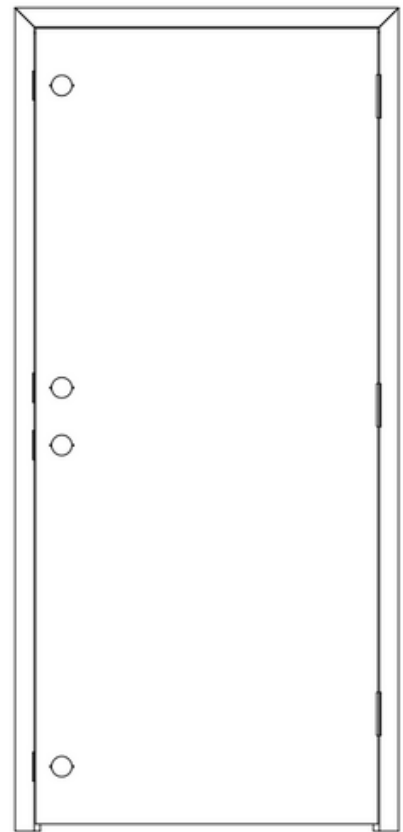

### DURABLE FINISH

- Mesker anti-corrosion primer standard
- G90 galvanized products are unprimed

# SEVERE WEATHER - TORNADO

## FEMA ICC-500 COMMUNITY SHELTER (361)

### TORNADO RATED ASSMBLIES FOR COMMUNITY STORM SHELTER APPLICATIONS

Mesker's community storm shelter opening assembly includes a 14 ga. door reinforced with a 14 ga. inner skin and a polystyrene core, 14 ga. welded frame, continuous or heavy-weight butt hinges, and three point locking hardware. This certified assembly is tested to resist a 15lb 2x4, propelled at 100MPH, and to withstand pressures of 1.75PSI for 5-seconds - the missile speed and pressure correlates to a 250MPH tornado.

### CONSTRUCTION

- Door Skins: 14 ga.
- Inner Skin: 14 ga. (applied to impact face)
- Frame: 14 ga.
- Hardware: tested with continuous or heavy-weight butt hinges and Securitech three point lock
- Tab-and-Slot construction mechanically locks the pan and lid together
- Adaptable non-handed design standard
- Premium high-frequency top hinge reinforcement adds strength and durability where other doors fail most often
- 14 ga. closer reinforcements included
- Steel Type: A40 galvanized steel standard; A60 galvanized and G90 galvanized optional
- Extra heavy-duty 7 ga. hinge reinforcements



### CERTIFICATIONS

- Up to 3-hr fire rating - FM, UL, Intertek
- FEMA ICC-500 Community Shelter

### DURABLE FINISH

- Mesker anti-corrosion primer standard
- G90 galvanized products are unprimed

# SEVERE WEATHER - HURRICANE

## HURRICANE RATED DOOR, FRAME, AND HARDWARE ASSEMBLIES

Mesker's hurricane assemblies are available in a wide range of configurations to satisfy a variety of certification requirements, to include: Florida Building Code (FBC), Miami-Dade NOA, and Texas Department of Insurance (TDI). These assemblies include approvals for High-Velocity Hurricane Zones (HVHZ), non-HVHZs, impact and non-impact zones. Available for single and paired openings, flush or glazed.

### CONSTRUCTION

- Assemblies include hurricane rated door, hurricane rated frame, and applicable tested hardware
- Tab-and-Slot construction mechanically locks the pan and lid together
- Adaptable non-handed design standard; beveled edges optional
- Premium high-frequency top hinge reinforcement adds strength and durability where other doors fail most often
- 14 ga. closer reinforcements included
- Versatile top/bottom channels with optional embossed flush bolt guides
- Steel Type: A40 galvanized steel standard; A60 galvanized and G90 galvanized optional
- Extra heavy-duty 7 ga. hinge reinforcements

### CERTIFICATIONS

- Up to 3-hr fire rating - FM, UL, Intertek
- Florida Building Code (FBC), Miami-Dade NOA, Texas Department of Insurance (TDI)

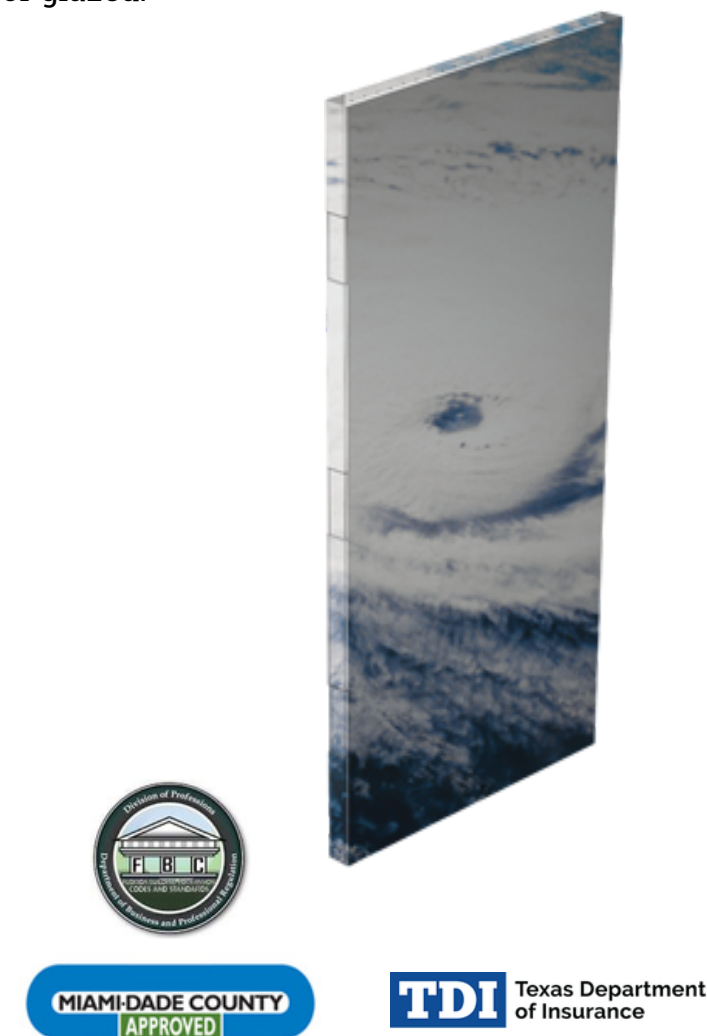

### DURABLE FINISH

- Mesker anti-corrosion primer standard
- G90 galvanized products are unprimed

# BR-SERIES BULLET RESISTANT OPENINGS

## DOOR & FRAME ASSEMBLIES TO DEFLECT UP TO LEVEL 3 SPSA AMMUNITION

Engineered to resist, at close range, Level 3 SPSA ammunition, Mesker's BR-Series bullet resistant openings leverage the classic Mesker door construction with additional 14 ga. interior plates.

### CONSTRUCTION

- Assemblies include bullet resistant door paired with a bullet resistant welded frame
- Tab-and-Slot construction mechanically locks the pan and lid together
- Door Skin: 14 ga.
- Inner Skin: 14 ga.
- Frame: 14 ga. with inner sleeve
- Deflects up to Level 3 SPSA ammunition
  - Level 1: .38 caliber
  - Level 2: .357 caliber
  - Level 3: .44 caliber
- Premium high-frequency top hinge reinforcement adds strength and durability where other doors fail most often
- 14 ga. closer reinforcements included
- Versatile top/bottom channels with optional embossed flush bolt guides
- Steel Type: A40 galvanized steel standard; A60 galvanized and G90 galvanized optional
- Extra heavy-duty 7 ga. hinge reinforcements
- Vision lite: 10" x 10" min., 28" x 58" max. with appropriate glazing (cutout only by Mesker, glazing by others)

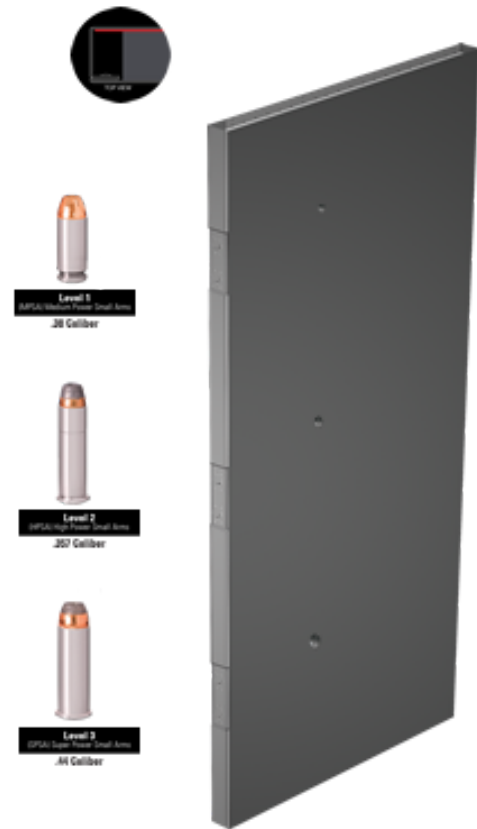

### CERTIFICATIONS

- UL752-11
- Up to 3-hr fire rating - FM, UL, Intertek

### DURABLE FINISH

- Mesker anti-corrosion primer standard
- G90 galvanized products are unprimed

JANUARY 2026



PROUDLY ENGINEERED AND  
MANUFACTURED IN THE UNITED  
STATES OF AMERICA

**MESKER DOOR**

3440 STANWOOD BLVD NE  
HUNTSVILLE, AL 35811  
256.851.6670

**MESKER SERVICE CENTER**

2400 SKYLINE DR. #300  
MESQUITE, TX 75149  
866.936.7001

**HOLLOW METAL XPRESS**

1120 N. 47<sup>TH</sup> AVE.  
PHOENIX, AZ 85043  
469.872.4086

[MESKERDOOR.COM](http://MESKERDOOR.COM)

**Your Trusted Source  
for Hollow Metal**