

## Through and through, our metal frames stand strong

As the oldest hollow metal fabricator in the United States, Mesker is the nationwide authority for many architects and contractors. We are committed to providing the best hollow metal products for the best value. We listen to our customers' needs and utilize superior engineering knowhow. We use only premium components and we guarantee complete customer satisfaction. Our system is a steadfast strategy which rewards our customers for their investment in Mesker. Much like our doors, we offer a complete line of hollow metal frames which boast the ingenuity and ruggedness you expect. Our frames are quality engineered, resulting in long frame life and best-in-class fit & finish. Mesker's strength not only comes from our premium components, but also in our value. We offer exceptional quality at a price the buyer will appreciate. We offer many styles including communicating, double egress, single rabbet, cased opening, and equal rabbet frames in a variety of stock sizes, profiles and face widths. To ensure superior fit and finish, and maximum product life, every Mesker frame is manufactured as specified:

### 7 GAUGE HINGE REINFORCEMENTS

- For the Strongest Applications = Maximum Load Strength + Sag Resistance
- Mesker's Standard Frame Hinge Locations are 5" (from Top of Frame Rabbet to Top of Top Hinge), 10" (from Bottom of Frame to Bottom of Bottom Hinge), and EQUAL (the center hinge is equidistant from the top and bottom hinges)
  - Mesker's Standard Frame Strike Location is 40-5/16"
  - All SDI Manufacturer's Locations, and custom locations, are available.



### DURABLE FINISH

- Mesker Primed Grey (Standard)
  - Water Based, Flow Coat, Baked On Finish
- Unprimed GALV or G90 Galv. (Optional)



(Optional)  
Thousands of Colors Available

## TIGHT BEND LINES

- Sharp, Crisp Corners and tight Bend Lines Every Time
- Great Fit Creating Smooth Welding Transitions



## 4-TAB LOCKING SYSTEM & PERFECT MITERED CORNERS

- Perfect Alignment
- Added Strength



## PREMIUM COMPONENTS

- 14 gauge Projection Welded One Piece Strike Reinforcements to Ensure Optimal Safety and Security
- Factory Installed Plaster Guards Standard on All F Series Hinge Reinforcements
- 16 gauge Floor Anchors Standard on All F Series Hinge and Strike Jamb
- 14 gauge Closer Reinforcement (optional)
- Wide Selection of Anchors Available for a Variety of Installation Applications.

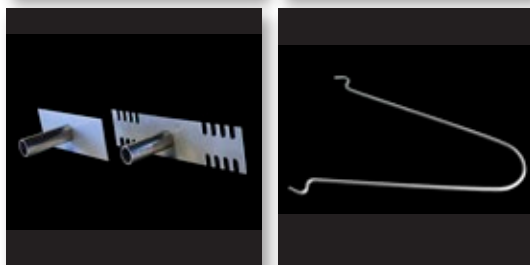

## A VARIETY OF FRAME PROFILES AVAILABLE

- Drywall & Masonry Frames
- Pocket, Kerfed, & Thermal Break Frames
- RF - Adjustable Frames, Remodel Frames, & ProHung Frames
- Flush Face, Double Egress, Hospital Stop, & Cased Open Frames
- Unequal and Equal Rabbet, Single and Double Rabbet Frames



## THE STRONGEST STEEL

- 16 Gauge (Standard)
  - 14 & 12 gauge Available
- CRS (Standard)
  - GALV and G90
  - Primed Available

American  
Recycled Steel



## WELDED FRAMES AND UNIQUE ELEVATIONS AVAILABLE

- Mullion and Stick
- 3 Sided Welded Frames
- Elevations
- Curved & Arched Top Frames



M E M B E R

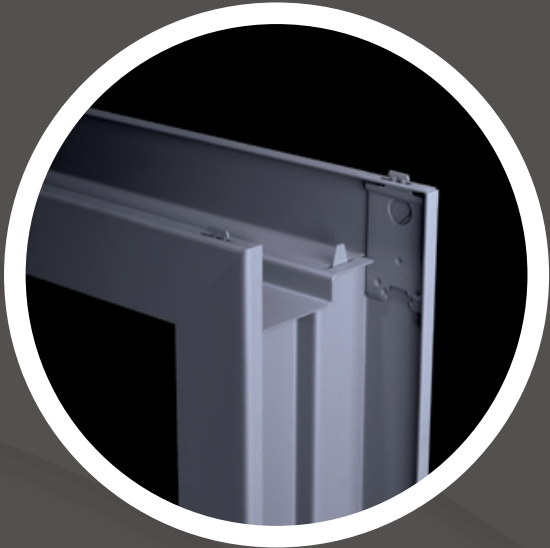

## MASONRY FRAMES (F-SERIES)

The standard F-SERIES Masonry Frame is the best stock hollow metal assembly in the industry. In fact, we have proven our caliber for more than 150 years — a testament to our craftsmanship.

We use only the best materials, like 12, 14, or 16 gauge cold rolled steel, G90 Galvanized or Galvannealed steel for corrosive applications. State-of-the-art technology is employed for consistent and accurate quality, such as our computer-controlled mig welders and an overhead trolley line paint booth. Mesker surpasses the industry requirements by using 3/16 inch hinge reinforcements to outlast the heaviest doors.

Our F-SERIES frames are fire-rated 3 hour and receive an embossed UL label standard.

## DRYWALL FRAMES (FDJ-SERIES, Afterset)

There is a major difference in our FDJ-SERIES drywall frame when compared with other competitors. We use only 16 gauge cold-rolled or Galvannealed steel, not the thinner gauges manufactured by many competitors. Our heavy gauge frames are designed to be pressure-fitted to the wall which improves unit life, and ensures durability with less torsion and sagging.

Because we use heavier gauge steel for our frame, stronger 3/16 inch hinge reinforcements can be welded to the rigid structure to hang heavier wood or metal doors.

Average installation time is 4-5 minutes per frame using our adjustable jamb lock for secure anchoring. Additionally, two dimpled holes at the base of each jamb stabilize the frame during installation.

Our FDJ-series frames are fire-rated 1-1/2 hours and receive an embossed UL label standard.

## FLUSH FACE FRAMES (FF SERIES)

Our flush face frames are built without returns and are designed to sleeve the wall after wall construction is complete. The unique face of the FF Series frame is designed with nail and screw holes punched into the face of the frame for easy installation into the finished wall, to be finished with a sharp, aftermarket casing/trim section. The oblong holes are positioned to screw the trim to the wall stud, without having to drill through the 16 gauge frame material.

- Available Fire Rated up to 1-1/2 Hours.

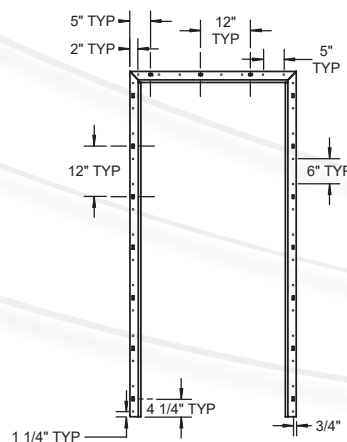

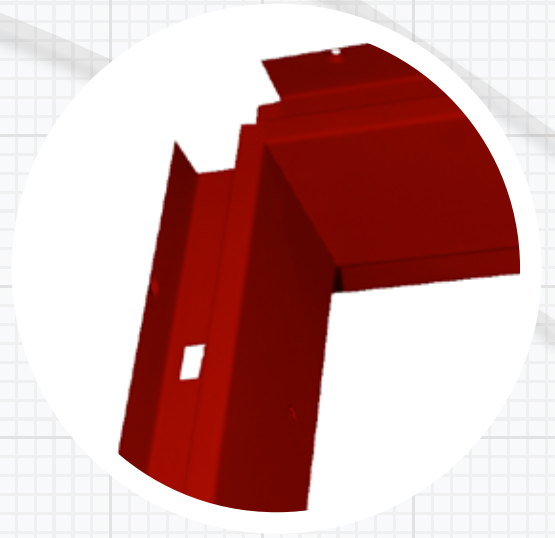

## REMODELING FRAMES (RF SERIES)

Mesker remodeling units are ideal for any existing wall structure. Comprised of six individual components, they are formed from rigid, 16 or 14 gauge steel, and can be ordered in an array of profiles and jamb depths. An individual header, hinge jamb, strike jamb, and the counterpart trim sections help the installer to make an adjustable, custom fit for each opening.

Countersunk holes in the faces of the frame for fastening to the side walls provide the flexibility to true <sup>UP</sup> the opening while providing a custom installation, and sure fit every time.

- Available Fire Rated up to 1-1/2 Hours.

## PROHUNG SERIES (RF-ProHung SERIES)

A state of the art prefinished frame system for retrofit, remodel, and new construction. This unique design combines the best of the RF Series with prefinished paint, and a custom anchoring system. Add a prefinished metal or wood door, and the accompanying hardware preinstalled, and you have a dream of an installation - Fast, Clean, and Finished - direct from Mesker.

- Available Fire Rated Up To 1-1/2 Hours.

## ADJUSTABLE FRAMES (ADJ SERIES)

The adjustable frame from Mesker allows you to lower your inventory costs, while increasing your service levels to the marketplace. By lowering your inventory costs on odd jamb depths, you now have the flexibility to tackle odd and custom jamb depths right out of your inventory. This durable frame product is manufactured in a heavy 16 gauge construction, Unprimed, Galvannealed for maximum longevity. The versatility of the Mesker Adjustable Frame allows you to cover a wide variety of wall thickness and a majority of your frame inventory needs with 2 basic adjustable frame sizes.

- Small for Wall Thicknesses of 5-5/8" to 8-3/4"
- Large for Wall Thicknesses of 8-3/4" to 12"
- Available Fire Rated Up To 1-1/2 Hours, Mitered or Butt Cut.

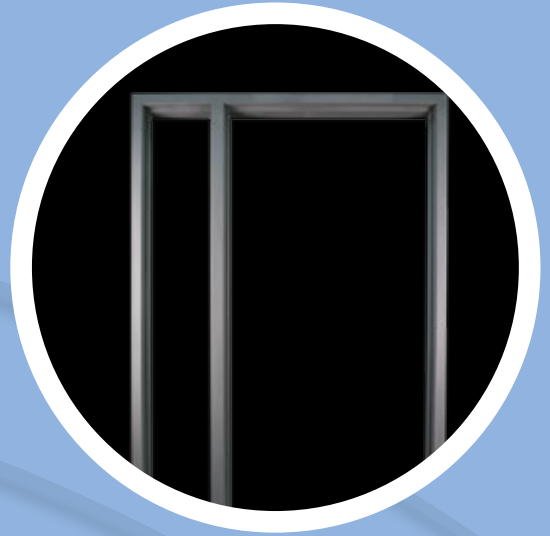

## STICK & MULLION, CUT & NOTCH, WELDED FRAMES AND ELEVATIONS

Create custom transom, side lite, window, and wall section designs using Mesker's innovative, pre-engineered stick and mullion sections. Mesker's stick sections have the same quality construction as our standard stock frames, and are available to you at affordable prices to inventory in your shop.

We can take it one step further by offering you the ability to order your material cut and notched to virtually any specification at our facilities. The cut and notched material is then shipped to you for final welding and fabrication in your shop.

Finally, we can take all of the work off your hands and give you a third option to take over full fabrication of your welded frames and custom elevations, factory finished at Mesker and shipped complete to your facility, or direct to your job site.

## THERMAL BREAK FRAMES

If keeping the heat in and the cold out during winter (or the cold in and the heat out in the summer) is a top priority, then consider utilizing Mesker's thermal break frame, as it is specified for improved thermal performance and energy efficiency.

- Non-rated for Exterior Application

## KERFED FRAME OPTION

This unique frame design from Mesker creates an integral kerfed slot in the frame stop to allow for built-in weatherstripping. The kerfed frame is designed to improve thermal performance, reduce noise, and provide a unitized solution for the frame / weatherstrip combination. Ideal for interior and exterior applications, such as hotel/motel, multi-family, public housing, assisted living, offices, hospitality, dormitories, and condominiums.

- Available in Masonry and Drywall Frames
- Available Fire Rated Up To 1-1/2 Hours

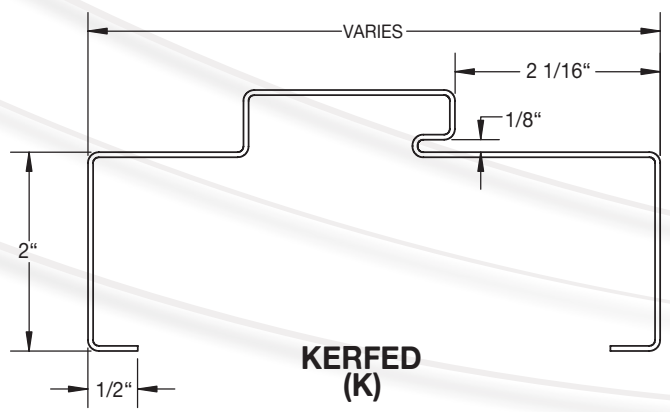

**KERFED (K)**



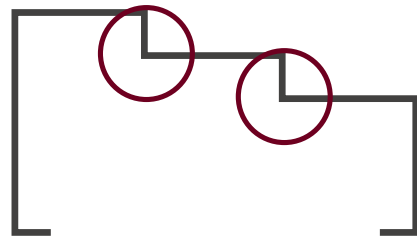

## DOUBLE EGRESS (DE) OPTION

The Mesker Double Egress Frame provides a means of egress in opposite directions through the same frame opening. Double Egress frames are ideal for hospitals, assisted living facilities, universities and other institutions where bi-directional corridor traffic is preferred.

- Available in Masonry and Drywall Frames
- Masonry Frames are available Fire Rated Up To 3 Hours
- Drywall Frames are Fire Rated Up To 1-1/2 Hours

## HOSPITAL STOP OPTION

The Mesker Hospital Stop frame provides stops at a 45 degree angle, (at 4", 6", or 8" above the floor), to allow space for health care facilities to effectively clean, sweep, and mop around the base of the frame without the stop getting in the way. This helps prevent the ability of bacteria to hide in the bends of the frame stop, and allows effective sanitation in high traffic areas. Hospital stop frames are ideal for any facility where heavy cleaning and mopping occur around the doorways. This is especially true for hospitals, nursing homes, assisted living facilities and other healthcare facilities.

- Available in Masonry and Drywall Frames
- Masonry Frames are available Fire Rated Up To 3 Hours
- Drywall Frames are Fire Rated Up To 1-1/2 Hours

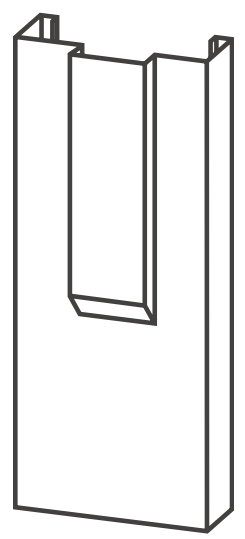

## CASED OPEN OPTION

The Mesker Cased Open frame is designed to frame out an opening through a wall where no door is desired. This same frame is designed as the frame of choice for double acting doors.

- Available in Masonry and Drywall Frames
- Masonry Frames are available Fire Rated Up To 3 Hours
- Drywall Frames are Fire Rated Up To 1-1/2 Hours

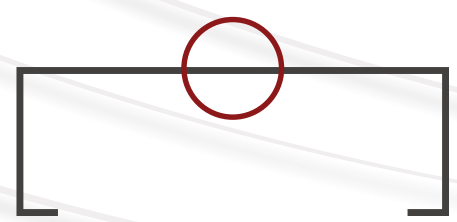



# MESKER STAINLESS FRAMES

- Face welded or KD-drywall construction
- 16, 14, or 12 guage available
- Type 304 standard
  - 316 available
- #4 brushed finish standard
  - #2B mill finish available
- All stainless steel components
- Standard and custom profiles
- Custom elevation sidelites, borrowed lites, transoms, etc.

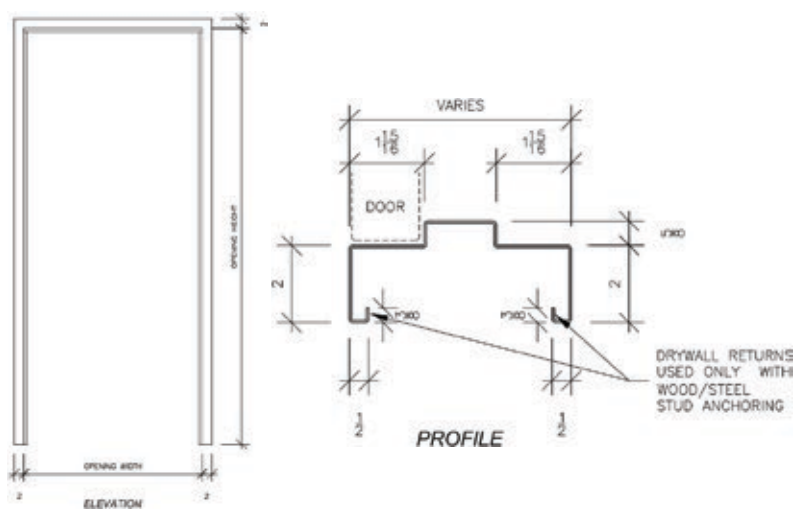

# STAINLESS HARDWARE

Our Design Hardware™ brand also offers products in 304 Grade Stainless Steel or 316 Marine Grade Stainless Steel. Call or Email us for function, options, and pricing.

## X SERIES



Our Popular X Series Cylindrical Lock is available in 316 Marine Grade

## BB5



Our Popular BB5 hinges are available in 316 Marine Grade Stainless Steel or the standard 304 Grade Stainless Steel

## 1000 SERIES



Our Popular 1000 Series Exit Device, KIL and LE08 Trim are available in 316 Marine Grade Stainless Steel or the standard 304 Grade Stainless Steel

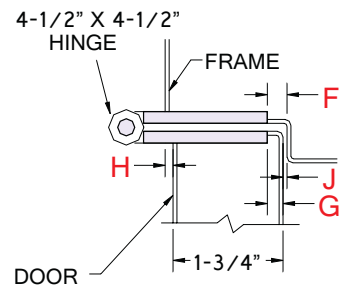
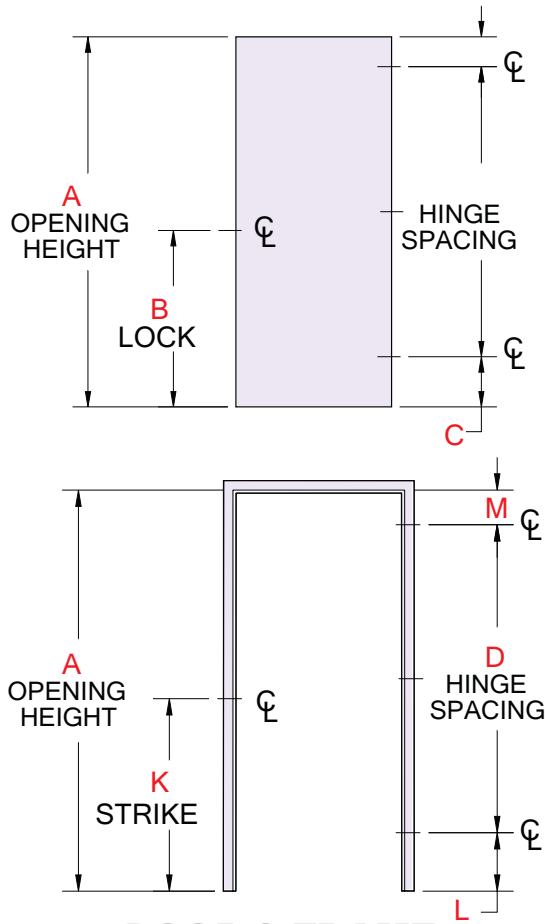

**DOOR & FRAME  
HARDWARE LOCATIONS**

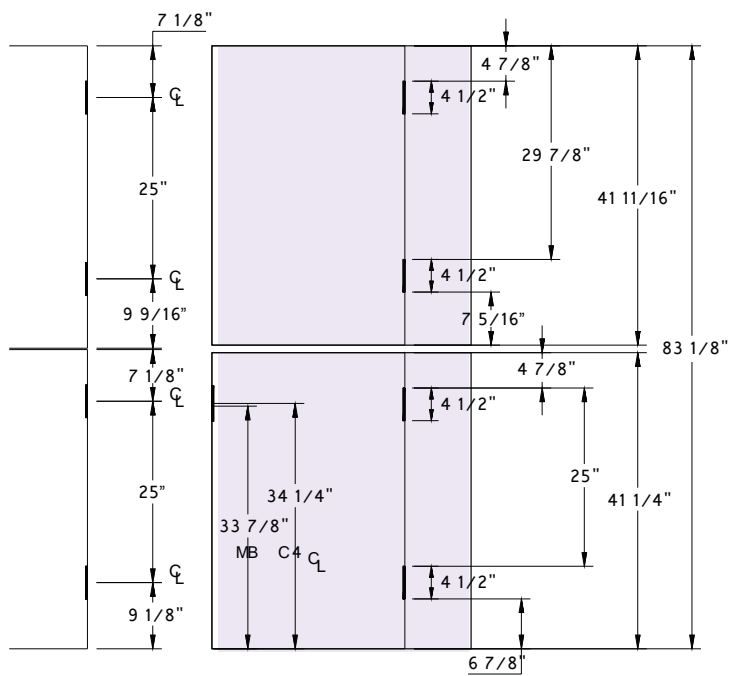

**DUTCH DOOR HINGE LOCATIONS**

**INTERIOR SIDE**

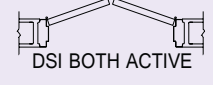
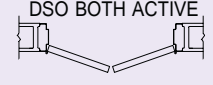
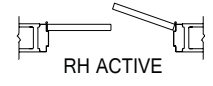
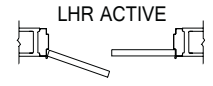
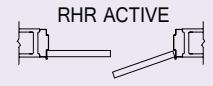
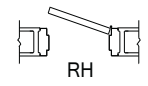
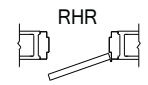
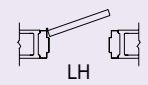
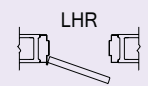

**EXTERIOR SIDE**

**HANDING**

**DOOR AND FRAME HARDWARE COMPARISON CHART**

4-1/2" Hinge & Strike Comparison (1 3/4" Door)

	A	B	C	D	E	F	G	H	J	K	L	M	
<b>AMWELD</b>	6'-8" 6'-10" 7'-0" 7'-2" 7'-4" 7'-6" 7'-8" 7'-10" 8'-0"	C4=39-9/16" MB=39-3/16"	9-5/8" 7-5/8" 9-5/8" 11-5/8" 9-5/8" 11-5/8" 9-11/16" 7-9/16" 9-9/16"	2 @ 29-15/16" 2 @ 31-15/16" 2 @ 31-15/16" 2 @ 31-15/16" 2 @ 33-15/16" 2 @ 33-15/16" 3 @ 23-15/16" 3 @ 25-5/16" 3 @ 25-5/16"	9-5/8" (7-3/8")	5/16"	3/16"	1/16"	1/8"	40-5/16"	10-3/8" 8-3/8" 10-3/8" 12-3/8" 12-3/8" 10-7/16" 8-5/16" 10-5/16"	9-3/4"	
<b>BENCHMARK</b>	6'-8" 6'-10" 7'-0" 7'-2" 7'-4" 7'-6" 7'-8" 7'-10" 8'-0"	C4=39-9/16" MB=39-3/16"	11-1/2" 13-1/2" 11-1/2" 11-1/2" 13-1/2" 7-1/2" 9-1/2" 11-1/2"	2 @ 30-1/4" 2 @ 30-1/4" 2 @ 32-1/4" 2 @ 32-1/4" 2 @ 34-1/4" 2 @ 34-1/4" 3 @ 25-1/2" 3 @ 25-1/2" 3 @ 25-1/2"	7-1/8" (4-7/8")	11/32"	1/4"	1/8"	3/32"	40-5/16"	12-1/4" 14-1/4" 12-1/4" 14-1/4" 12-1/4" 14-1/4" 8-1/4" 10-1/4" 12-1/4"	7-1/4"	
<b>CECO</b>	6'-8" 6'-10" 7'-0" 7'-2" 7'-4" 7'-6" 7'-8" 7'-10" 8'-0"	C4=41-1/16" MB=40-11/16"	8-1/4"	2 @ 31" 2 @ 32" 2 @ 33" 2 @ 34" 2 @ 35" 2 @ 36" 3 @ 24-21/32" 3 @ 25-21/64" 3 @ 26"	8-7/8" (6-5/8")	5/16"	1/4"	1/8"	1/16"	41-13/16"	9"	9"	
<b>COPCO</b>	6'-8" 6'-10" 7'-0" 7'-2" 7'-4" 7'-6" 7'-8" 7'-10" 8'-0"	C4=39-9/16" MB=39-3/16"	9-5/8"	2 @ 29-15/16" 2 @ 30-15/16" 2 @ 31-15/16" 2 @ 32-15/16" 2 @ 33-15/16" 2 @ 34-15/16" 3 @ 23-19/64" 3 @ 24-19/64" 3 @ 25-19/64"	9-5/8" (7-3/8")	5/16"	7/32"	1/32"	3/32"	40-5/16"	10-3/8"	9-3/4"	
<b>CURRIES</b>	6'-8" 6'-10" 7'-0" 7'-2" 7'-4" 7'-6" 7'-8" 7'-10" 8'-0"	C4=39-1/4" MB=38-7/8"	11-1/2"	2 @ 30-1/4" 2 @ 31-1/4" 2 @ 32-1/4" 2 @ 33-1/4" 2 @ 34-1/4" 2 @ 35-1/4" 3 @ 24-1/8" 3 @ 24-7/8" 3 @ 25-1/2"	7-1/8" (4-7/8")	5/16"	1/4"	1/8"	1/16"	40"	12-1/4"	7-1/4"	
<b>DEANSTEEL</b>	6'-8" 6'-10" 7'-0" 7'-2" 7'-4" 7'-6" 7'-8" 7'-10" 8'-0"	C4=39-9/16" MB=39-3/16"	11-1/2"	2 @ 30-1/4" 2 @ 31-1/4" 2 @ 32-1/4" 2 @ 33-1/4" 2 @ 34-1/4" 2 @ 35-1/4" 24-1/8", 24-1/4", 24-1/8" 24-7/8", 24-3/4", 24-7/8" 3 @ 25-1/2"	7-1/8" (4-7/8")	5/16"	1/4"	1/8"	1/16"	40-5/16"	12-1/4"	7-1/4"	
<b>KEWANEE</b>	6'-8" 6'-10" 7'-0" 7'-2" 7'-4" 7'-6" 7'-8" 7'-10" 8'-0"	C4=39-9/16" MB=39-3/16"	9-1/2"	2 @ 30-1/16" 2 @ 31-1/16" 2 @ 32-1/16" 2 @ 33-1/16" 2 @ 34-1/16" 2 @ 35-1/16" 24-1/16", 24", 24-1/16" 24-11/16", 24-3/4", 24-11/16" 3 @ 25-3/8"	9-1/2" (7-1/4")	3/8"	1/4"	1/16"	1/8"	40-5/16"	10-1/4"	9-5/8"	
<b>MESKER</b>	6'-8" 6'-10" 7'-0" 7'-2" 7'-4" 7'-6" 7'-8" 7'-10" 8'-0"	C4=39-9/16" MB=39-3/16"	11-1/2" 11-1/2" 11-1/2" 11-1/2" 11-1/2" 11-1/2" 10-1/2" 9-1/2" 11-1/2"	2 @ 30-1/4" 2 @ 31-1/4" 2 @ 32-1/4" 2 @ 33-1/4" 2 @ 34-1/4" 2 @ 35-1/4" 3 @ 24-1/2" 3 @ 25-1/2" 3 @ 25-1/2"	7-1/8" (4-7/8")	5/16"	1/4"	1/8"	1/16"	40-5/16"	12-1/4" 12-1/4" 12-1/4" 12-1/4" 12-1/4" 11-1/4" 12-1/4" 10-1/4" 12-1/4"	7-1/4"	
<b>PIONEER</b>	6'-8" 6'-10" 7'-0" 7'-2" 7'-4" 7'-6" 7'-8" 7'-10" 8'-0"	C4=37-1/4" MB=36-7/8"	11-1/2" 11-1/2" 11-1/2" 11-1/2" 11-1/2" 11-1/2" 11-7/16" 11-9/16" 11-1/2"	2 @ 30-1/4" 2 @ 31-1/4" 2 @ 32-1/4" 2 @ 33-1/4" 2 @ 34-1/4" 3 @ 23-1/2" 3 @ 24-3/16" 3 @ 24-13/16" 3 @ 25-1/2"	7-1/8" (4-7/8")	5/16"	7/32"	3/32"	3/32"	38"	12-1/4" 12-1/4" 12-1/4" 12-1/4" 12-1/4" 12-1/4" 12-3/16" 12-5/16" 12-1/4"	7-1/4"	
<b>REPUBLIC</b>	6'-8" 6'-10" 7'-0" 7'-2" 7'-4" 7'-6" 7'-8" 7'-10" 8'-0"	C4=39-9/16" MB=39-3/16"	9-5/8" 11-1/2" 11-5/8" 11-5/8" 11-1/2" 11-1/2" 11-5/8" 11-3/8" 11-1/2"	2 @ 29-15/16" 2 @ 31-1/4" 2 @ 29-15/16" 2 @ 30-15/16" 2 @ 34-1/4" 2 @ 35-1/4" 3 @ 24-1/8" 3 @ 24-7/8" 3 @ 25-1/2" 2 @ 29-15/16" 2 @ 30-15/16" 2 @ 31-15/16" 2 @ 32-15/16" 2 @ 33-15/16" 2 @ 34-15/16" 3 @ 23-61/64" 3 @ 24-5/8" 3 @ 25-19/64"	9-5/8" (7-3/8") 7-1/8" (4-7/8") 11-5/8" (9-3/8") 11-5/8" (9-3/8") 7-1/8" (4-7/8") 7-1/8" (4-7/8") 7-1/8" (4-7/8") 7-1/8" (4-7/8") 7-1/8" (4-7/8")	5/16"	1/4"	1/8"	1/16"	40-5/16"	10-3/8" 12-1/4" 12-3/8" 12-3/8" 12-1/4" 12-1/4" 12-3/8" 12-1/8" 12-1/4"	9-3/4" 7-1/4" 11-3/4" 11-3/4" 7-1/4" 7-1/4" 7-1/4" 7-1/4" 7-1/4"	
<b>STEELCRAFT</b>	6'-8" 6'-10" 7'-0" 7'-2" 7'-4" 7'-6" 7'-8" 7'-10" 8'-0"	C4=39-9/16" MB=39-3/16"	9-5/8"	2 @ 29-15/16" 2 @ 30-15/16" 2 @ 31-15/16" 2 @ 32-15/16" 2 @ 33-15/16" 2 @ 34-15/16" 3 @ 23-61/64" 3 @ 24-5/8" 3 @ 25-19/64"	9-5/8" (7-3/8")	5/16"	1/4"	1/8"	1/16"	40-5/16"	10-3/8"	9-3/4"	

NOTE 1: Dimension "B" is shown for a standard cylindrical (C4) preparation. Subtract 3/8" from dimension for a standard mortise (MB) preparation.  
 NOTE 2: Dimension "E" in parenthesis ( ) — is measured from the top of door to top of the 1st hinge.